

TECHNICAL BULLETIN

Document:	TB_T318_027_RIS_tether		Rev: 01
Date:	06/03/2020		
Subject:	RIS tether		
Reference:	Table	Item	Code
Accomplishment:	2020 racing season		

According to FIA safety prescriptions, Tatuus developed a solution in order to fit a tether cable for the Rear Impact Structure.

Please find in Figure 1 and in Table 1 the list of the items to be installed on the car.

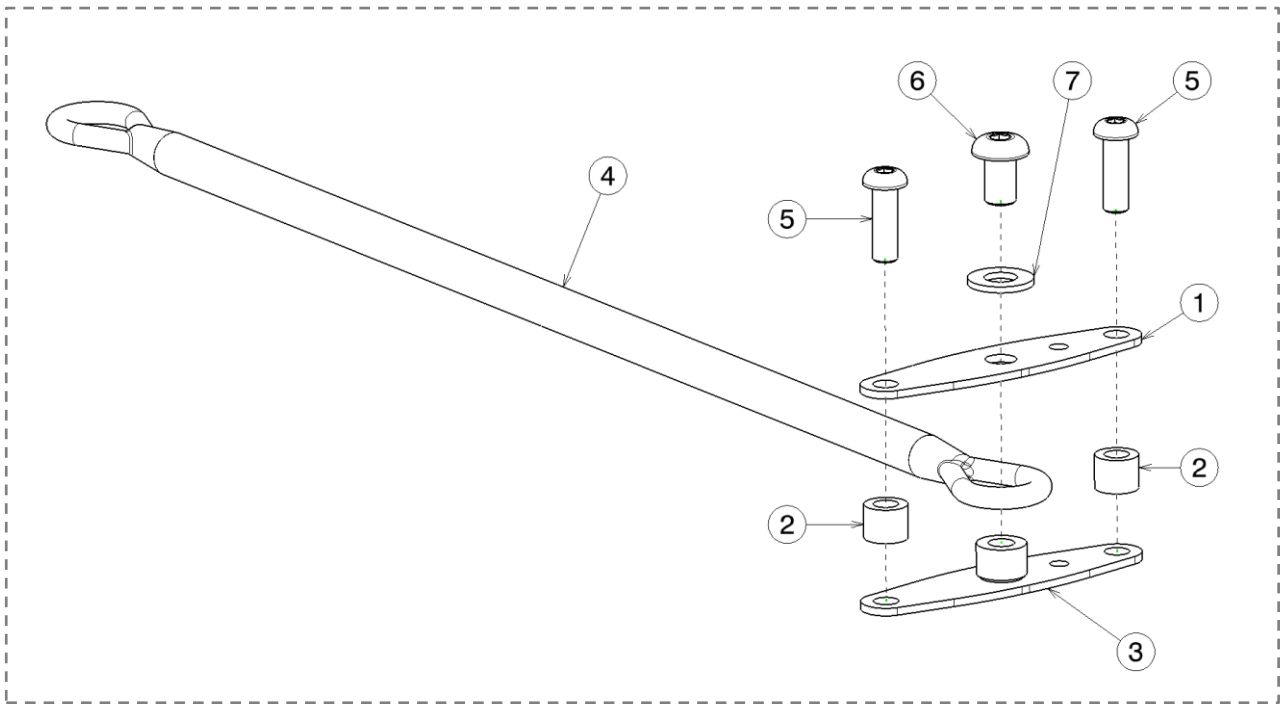

Figure 1

Table 1

Item	Part Number	Description	Qty
1	2401056001	RIS tether plate	1
2	2401056002	Bush	2
3	2401056004	RIS tether bracket	1
4	2401058	Tether	1
5	UNI7380-M8X30	SHBS screw	2
6	UNI7380-M10X16	SHBS screw	1
7	UNI6592-10	Plain washer	1

All the parts listed above can be purchased in a kit, please find below part number and price

Part Number	Description	Price (€)
2401056	RIS tether KIT	295.88